

**40+ MILLION**  
**SAFE & HAPPY FAMILIES**  
WORLD WIDE

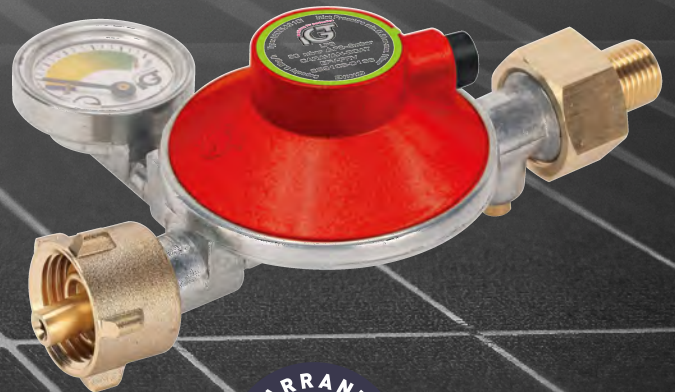

**RV-  
Caravan  
Gas Fittings**



# Enjoy The Safety & Comfort of Safe Gas Consumption While Driving



## CONTENT

01	About Us
02	Gas Connection Solution for Caravans
03	Gazview
04	Regulators
05	Accessories



DENMARK

## Welcome to Integrated Gas Technologies

IGT is one of the Global leaders in the market for regulators and hoses for butane and propane cylinders.

IGT Headquartered in Denmark has two factories, NBSX located in Ningbo, China since 2004 and IGCT located in Hyderabad, India since 2016. IGT employs 245 people.

IGT uses the best raw materials such as zamac3, brass, steel and rubber for all components. In addition, we perform 100% quality control on both assembly and assembled finished products.

All LPG regulators come with a 5 year product warranty and \$ 5 million product liability insurance.

The factories have been audited and approved among others by international gas appliance companies and meet the high standards of these customer segments. Both factories are ISO9001 certified and in 2014 the NBSX factory was also BSCI certified ([www.bsci-int.org](http://www.bsci-int.org)), a social enterprise initiative aimed at ensuring compliance with the European Code of Conduct on Social Responsibility.

IGT aligns its production with the 17 United Nations Sustainable Development Goals to achieve a better and more sustainable future for all of us.



## Gas Connection Solution for Caravans

### Single gas cylinder supplying line of the recreational vehicle.

#### Application example:

The low pressure regulator is connected directly to the gas cylinder. The medium pressure hose assembly creates the connection to the vehicle's supply line. The inbuilt manual excess flow valve allows use of gas while driving. According to EN1949.

To simplify traveling through out Europe with its different cylinder connections, we recommend a low pressure regulator with wall bracket.

The connection to the gas cylinder is made then with the suitable country-specific high pressure hose assembly without the low pressure regulator having to be replaced. Between the hose assembly and the low pressure regulator is a gas filter, which protects the connected fittings and devices from contamination.

With a gas out take quick connector valve gas equipment, such as barbecues and stoves, outside the vehicle can also be supplied via the internal LPG installation.

The connection to the gas equipment is made with a medium pressure hose assembly and a quick coupler on the vehicle. The vehicle owner no longer needs to carry any additional gas cylinders.

#### REGULATOR

For connection to gas cylinders to regulate the pressure to the nominal pressure of the gas equipment.

#### HOSE

Medium pressure hose assembly rubber, to connect fittings, consumer equipment and piping.

#### VALVE

Distributor valve, quick acting valve, only completely open or closed setting.

#### GAS FILTER DOUBLE CUP

The unique IGT double cup design allows draining and exchange of the absorption cotton pad without first depressurising the gas system. An inbuilt check valve prevents high-pressure gas inside the supply hose is released during the cotton pad exchange procedure.

#### GAS OUT TAKE BOX

to connect additional gas equipment, such as a stove, barbecue, lights etc.

#### GAZ VIEW

Gas weight for gas cylinders with display + bluetooth remote transmission of the measurement and signalling data to a smartphone or tablet, by the Gaz View app.



# Schematic Installation Setup

## REGULATOR

Reference  
A235isp-PM PRV



## HOSE

Reference  
S006-HP-450-001



## REGULATOR

Reference A311iep-PMV



## VALVE

Reference A900-250



## HOSE

Reference S006-C012

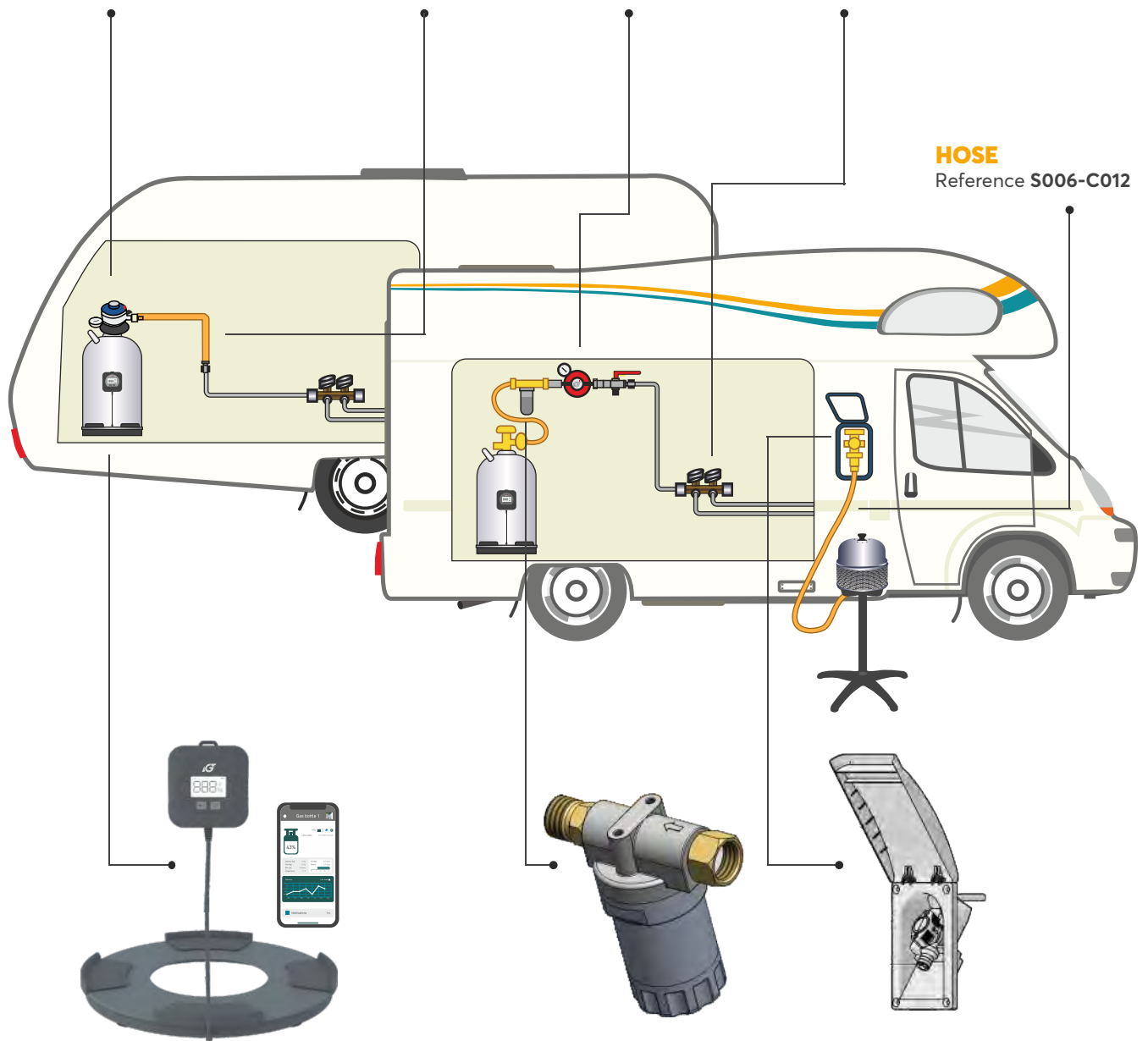

## GAZ VIEW

Reference H700-500



## GAS FILTER DOUBLE CUP

Reference A900-F011

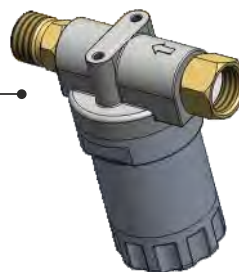

## GAS OUT TAKE BOX

Reference GB750-001

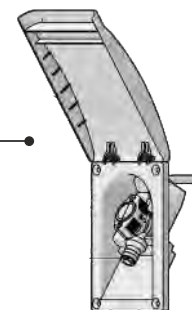

## 03 Gazview

GazView by weight devices primarily for control & monitoring of gas consumption in gas cylinders. Secondly for control of cooking thermometer, for outdoor gas bbq or indoor ovens.



### Water Tight Design , Corrosion Free Materials Impact Resistant

**Precise:** Accurately measures the filling level of your cylinder as a percentage and in kg and tells you estimated time to being empty.

**Convenient:** Easy to use and convenient to operate with Gazview App. Display for offline use.

**Practical:** It is easy to attach below the cylinder and remove when you replace the cylinder.

Works with all common European steel, Aluminum and composite gas cylinders.

#### Technical data

Weight (incl battery): 300g  
Dimension: 250mm diameter  
Power supply: 3V/2x1.5V alkaline AAA battery  
Power consumption: max. 70mA  
Operating temperature: -20°C to +50°C  
Bluetooth: Class 2  
Gas type: Propane/butane

Bluetooth - FCC approved for USA and EU.



# 04

## Regulators

Complys to EN16129/D



**Convenient:** The click on inlet allows easy mounting of regulator to gas cylinder. Manometer for gas leak test and indication of low gas level in cylinder on the visual display.

**Versatile:** Can also be used in commercial vehicles. National rules may apply.

**Application:** For use in Caravan, meet EN16129 appendix D. Installation shall be made to EN1949. Professional gas leak test as per EN1949 - recommended. DVGW arbeitslatt G607. Leak test to be conducted though the test point M5 on the ball valve. Observe hose length of Maximum 400 mm to cope tubing.

**Reference:** A235isp-PM PRV

### Technical data

Gas type: LPG  
Inlet: 35 mm  
Outlet: 1/4"LH - M20x1.5  
Capacity: 1.5kg/h  
Outlet pressure options: 30mbar  
With manometer for gas level/gas leak indication.  
With Manual Excess flow.  
360degree rotating manometer.  
Regulator Size: Diameter 63mm

### Inlets Available

35 mm - DK-NO-FI-ES-PT-IE-EE-CY-BG  
\*BG - Special spindle needed  
16mm - TR



**Convenient:** See the operating status of the gas cylinders (empty/full) on the visual display

**Versatile:** Can also be used in commercial vehicles. National rules may apply.

**Application:** For use in Caravan, meet EN16129 appendix D. Installation shall be made to EN1949. Professional gas leak test as per EN1949 - recommended. DVGW arbeitslatt G607. Leak test to be conducted though the test point M5 on the ball valve. Observe hose length of Maximum 400 mm to cope tubing.

**Reference:** A311iep- PM PRV

### Technical data

Gas type: LPG  
Inlet: Numerous possible types of inlet  
Outlet: 1/4"LH - M20x1.5  
Capacity: 1.5kg/h  
Outlet pressure options: 30mbar  
With manometer for gas level/gas leak indication. With Manual Excess flow.  
360degree rotating manometer.  
Regulator Size: Diameter 63mm

### Inlets Available

G1 - IT-GR  
G2 - FR-CH-LV-LT-CZ-SK-SL-H-BE  
G4 - HU-TR  
G5 - NL  
G7 - UK  
G8 - UK  
G10 - BE-IS-SE  
G12 - PL-DE-AT-CH-NL

## Regulators



**Convenient:** The Compact inlet allows easy mounting of regulator to gas cylinder. Manometer for gas leak test and indication of low gas level in cylinder on a visual display.

**Versatile:** Can also be used in commercial vehicles.

**Application:** For use in Caravan, meet EN16129 appendix D. Installation shall be made to EN1949. Professional gas leak test as per EN1949 - recommended. DVGW arbeitslatt G607. Leak test to be conducted though the test point M5 on the ball valve. Observe hose length of Maximum 400 mm to cope tubing.

**Reference:** A100isp-PRV

### Technical data

Gas type: LPG  
Inlet options: 20/21/22/25.6/27mm  
Outlet options: 1/4"LH - M20x1.5  
Capacity 1.5kg/h  
With manometer for gas level/gas leak indication.  
With Manual Excess flow.  
360degree rotating manometer.  
Regulator Size: Diameterø63mm

### Inlets Available

20mm - HU-PT-FR  
21mm - DK-UK  
22mm - MT-PT-IT  
27mm - UK-BE-FR



**Convenient:** Complete Set

**Reference:** A235is-PM270 with hose and ball valve with test point M5.

### Technical data

Gas type: propane/butane  
Inlet: 35 mm  
Outlet: 8mm/10mm/11m  
Capacity: 1.5 - 2.0 kg/h  
With Excess flow  
With safety on-off switch  
With manometer for gas level/gas leak indication  
360degree rotating manometer  
Regulator Size: Diameterø63mm

### Inlets Available

35mm - IE-DK-NO-FI-EE-CY-PT-ES  
BG - Special spindle version mandatory





## High Pressure Hoses assemblies with HP excess flow valves

### To connect the gas cylinder and regulator

High-pressure hoses with rupture protection

IGT Hose assembly is tested 100% gas tight by compressed air at 20bar. Rubber hose is recommended due to the longer durability, and fire resistance. It can last up to 10 years.

**Variable:** Eight different types are available, at 400 - 450 - 750 mm length.

### Advantages and equipment

can be used all over Europe through the use of high pressure hose assemblies with country-specific connections

### Technical data

Hose: Rubber with textile lining Class 3, EN16436

-30° "Winterfest"

300 NM pull force sleeves

Option: Steel Braided

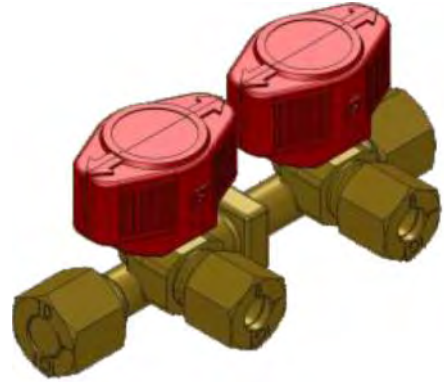

## Quick Acting Valve

Valves and connections guarantee the safe and fault free operation of your gas system. They comply with all important safety requirements and ensure the connected gas appliances work perfectly and can be shut off.

### Accessories for gas pressure regulation systems:

**Quick acting valves:** For shutting on/off gas lines.

**Manifold valves:** For the central connection of several gas applications. Heating - Stove - Fridge - Gas Outtake

**Coupling valves:** For connecting external appliances(e.g. gas barbecue).

### Safe connection and attachment:

EN8434 Compression fittings.

Double O - Ring seal design for long life.

Option: Steel nut & sleeves for steel tubes

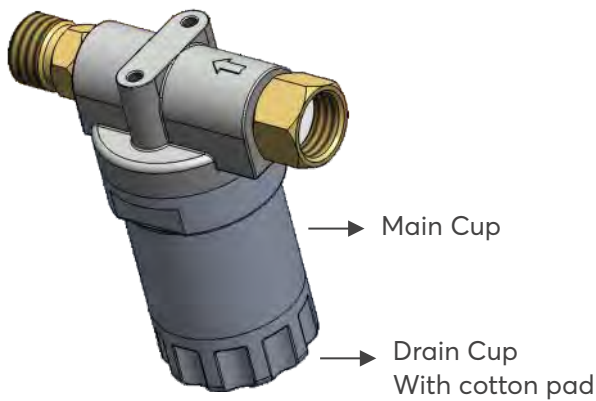

## Gas Filter Double Cup

Protects the gas system against oiling and dirt IGT gas filter effectively protects the gas system from contamination in gas cylinders. Oily particles are carried along with the gas flow as aerosols, depositing themselves in the regulators and blocking them. The new generation of IGT gas filters removes these residues from the gas and deposits them on a filter pad which is easy to replace by hand.

**Practical:** Change the Cotton pad and oil quickly and easily - every time you change the cylinder replace the cotton pad.

**Retrofittable:** Suitable for both wall-mounted gas pressure regulators systems and fittable tank gas cylinders.

### Technical data

Gas type: Propane/Butane/LPG  
 Maximum operating pressure: 25bar  
 Dimensions: approx 91 x 94 x55 mm  
 Weight(incl filter cartridge): 350g

Item No	Inlet	RVS 8 mm
A900-F001	RVS 8 mm	RVS 8 mm
A900-F002	RVS10 mm	RVS 10 mm
A900-F003	G1/4" Lh Male	G1/4" Lh Nut
A900-F004	M20x1,5 Male	M20x1,5 Nut
A900-F005	G5 Kombi	G12 KLF
A900-F999		Replacement filter
A900-F992		10 pcs gas pads

RVS 8 mm = 8 mm compression fitting to EN8434  
 RVS 10 mm = 10 mm compression fitting to EN8434

**Working pressure :** 16 bar

**Filter Unit :** Absorb 99% of dirt and heavy ends

**Gas pad in lower cup :** Cotton pad that absorb the liquid residue and dirt.

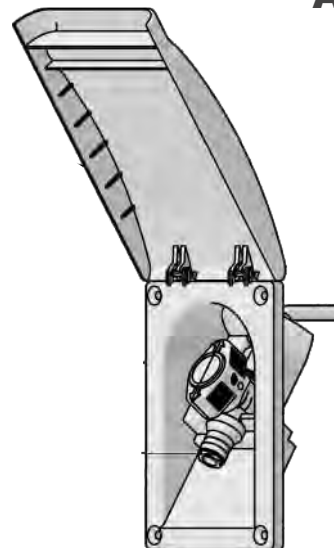

## Gas Outtake Box

### Gas extraction outside the vehicle

A gas out take point on your motor home or caravan enables you to conveniently connect external gas appliances such as a barbecue, cooker, patio heaters or lights.

To install the gas socket, you also need a gas pipe with 8 mm diameter, and to extract gas you need a hose with a plug-in quick coupling. The socket is suitable for gas appliances with an operating pressure of 30 mbar.

Click cover - closing soothingly

Quick acting valve with quick coupling - Only open for gas flow when gas hose is connected.

Exchangeable cover - Wind stable - Various colors.

Optimized design for valve on/off operation and connection of gas hose.

### Standard Colors:

- White – RAL9010
- Fiat white – Fiat210
- Light grey – NCS3000
- Charcoal grey – NCS7000



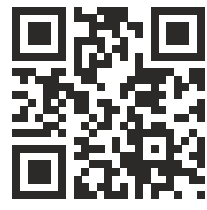

[WWW.IGT-LPG.COM](http://WWW.IGT-LPG.COM)



**HEAD OFFICE IN DENMARK**  
**INTEGRATED GAS TECHNOLOGIES**  
Gydevang 39-41 DK-3450 Allerød Denmark  
Tel: 0045-4576 9921 | Fax: 0045-4576 9821  
E: sales@igt-lpg.com | W: www.igt-lpg.com

**FACTORY IN CHINA**  
**NINGBO SHUAI XIAN REGULATOR CO. LTD**  
No 566, Jinshan Road, Zone C, Investment center  
Jiangbei District, Ningbo Zhejiang, China  
E: sales@igt-lpg.com | W: www.igt-lpg.com

**FACTORY IN INDIA**  
**INTEGRATED GAS CONTROLS TECHNOLOGIES PVT. LTD**  
Survey No.784, 14-59/3A,  
Medchal Village, Near Ravalkole  
"X" Road, Medchal Mandal  
& Medchal - Makajgir District.  
E: info@igt-lpg.in | W: www.igt-lpg.in

**40+**  
MILLION  
SAFE FAMILIES

**120+**  
COUNTRIES

**400+**  
PRODUCTS

**25+**  
CERTIFICATES